



THE OUTPOST

ROOM TYPE FACT SHEETS



THE OUTPOST

*Makuleke Private Concession,
Kruger National Park*

Cantilevered dramatically off a cliff with commanding views of the valley below, The Outpost is a masterpiece of contemporary lodge design. Guests are accommodated in 12 luxurious, free-standing spaces perched along the ridgeline, each with state-of-the-art retractable, remote-controlled screens offering 180° of uninterrupted views.

NO. OF GUEST SPACES	12
NO. OF ROOM TYPES	3
SINGLE SUPPLEMENT	YES
WHEELCHAIR FRIENDLY	YES (1 UNIT)
SUITABLE FOR THOSE WITH MOBILITY ISSUES	PLEASE ENQUIRE
CELLPHONE SIGNAL	NO
MAIN LODGE WIFI	YES
IN-ROOM WIFI	NO
SPA	YES (IN-ROOM)
GYM-IN-A-BASKET	YES
LAUNDRY SERVICE	YES
CONFERENCE FACILITY	PLEASE ENQUIRE





BUSH VIEW SPACES

4 units

Set lower on the rocky ridge, flanking the main lodge, our Bush View Spaces feel cool and contemporary, immersed in the wilderness and surrounded by birdlife. These free-standing units are open to the elements on three sides, with state-of-the-art retractable, remote-controlled screens in place of walls. They are furnished with a king-sized bed and feature a comfortable daybed, an open-plan bathroom with indoor/outdoor shower and oversized bathtub, a well-stocked mini bar and a generous balcony for taking in the view.

ROOM SIZE	64m ²
MAXIMUM NO. OF ADULT GUESTS	2
MAXIMUM NO. OF CHILDREN SHARING (AGED 10-12)*	1
OPTION FOR TWIN BEDS*	YES
MOSQUITO NETS	YES
AIR CONDITIONING	NO
CEILING FAN	YES
PRIVATE TERRACE	YES
OPEN-PLAN BATHROOM	YES
SEPARATE W.C.	YES
BATHTUB	YES
WALK-IN SHOWER	YES
MINI BAR	YES
HAIR DRYER	YES
TV	NO
DIGITAL SAFE	YES
WHEELCHAIR FRIENDLY	NO

**On request*

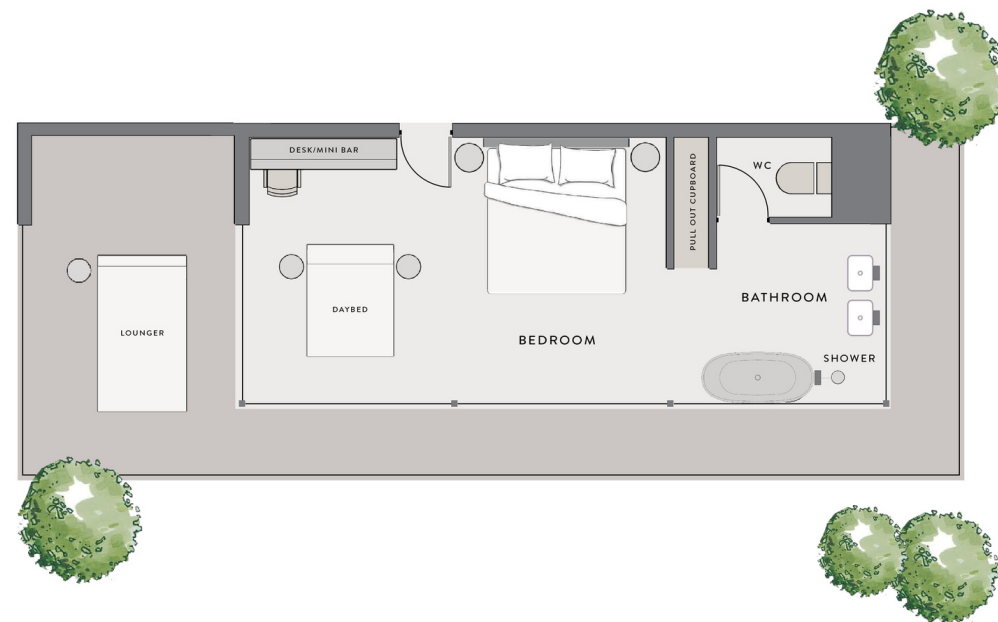



TREETOP SPACES

2 units

Nestled in a stand of ironwood trees, our Treetop Spaces feel as if they have been set down gently in the canopy. While the valley is visible through the trees, the experience in these spaces is much more immersive, with an even greater sense of privacy and seclusion. These free-standing units are open to the elements on three sides, with retractable, remote-controlled screens in place of walls. They are furnished with a king-sized bed and feature a comfortable daybed, an open-plan bathroom with indoor/outdoor shower and oversized bathtub, a well-stocked mini bar and a balcony for taking in the view.

ROOM SIZE	64m ²
MAXIMUM NO. OF ADULT GUESTS	2
MAXIMUM NO. OF CHILDREN SHARING (AGED 10-12)*	1
OPTION FOR TWIN BEDS*	YES
MOSQUITO NETS	YES
AIR CONDITIONING	NO
CEILING FAN	YES
PRIVATE TERRACE	YES
OPEN-PLAN BATHROOM	YES
SEPARATE W.C.	YES
BATHTUB	YES
WALK-IN SHOWER	YES
MINI BAR	YES
HAIR DRYER	YES
TV	NO
DIGITAL SAFE	YES
WHEELCHAIR FRIENDLY	NO

**On request*

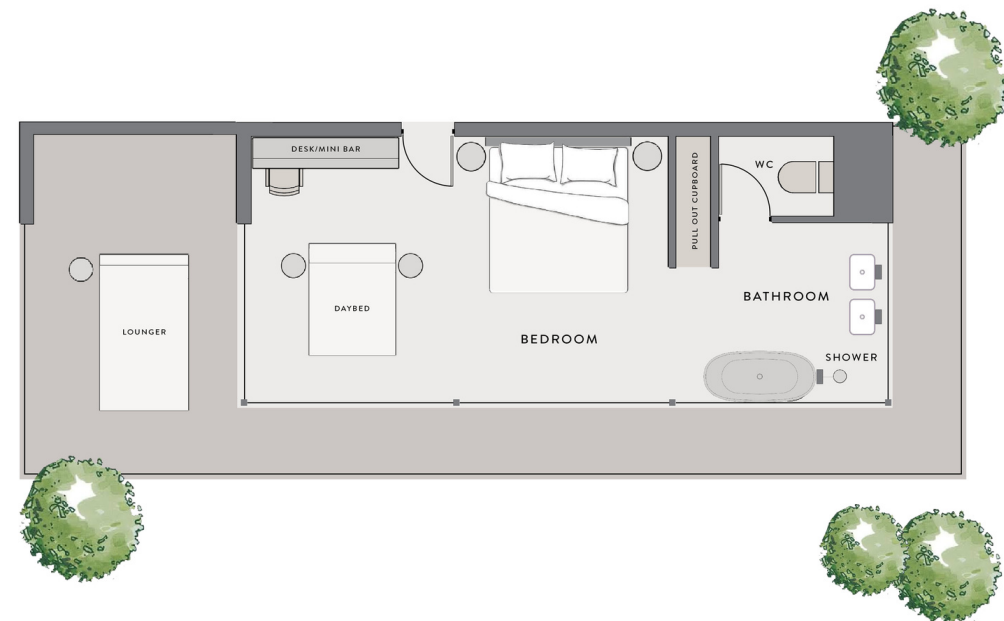



THE OUTPOST

RIVER VIEW SPACES

5 units

Dotted along the ridge with sweeping views of the Luvuvhu River and the surrounding wilderness, our River View Spaces offer a cocoon of comfort and luxury in the untouched beauty of the northern Kruger. These free-standing units are open to the elements on three sides, with state-of-the-art retractable, remote-controlled screens in place of walls. They are furnished with a king-sized bed and feature a comfortable daybed, an open-plan bathroom with indoor/outdoor shower and oversized bathtub, a well-stocked mini bar and a generous balcony for taking in the view.

ROOM SIZE	64m ²
MAXIMUM NO. OF ADULT GUESTS	2
MAXIMUM NO. OF CHILDREN SHARING (AGED 10-12)*	1
OPTION FOR TWIN BEDS*	YES
MOSQUITO NETS	YES
AIR CONDITIONING	NO
CEILING FAN	YES
PRIVATE TERRACE	YES
OPEN-PLAN BATHROOM	YES
SEPARATE W.C.	YES
BATHTUB	YES
WALK-IN SHOWER	YES
MINI BAR	YES
HAIR DRYER	YES
TV	NO
DIGITAL SAFE	YES
WHEELCHAIR FRIENDLY	YES (1 UNIT)

**On request*

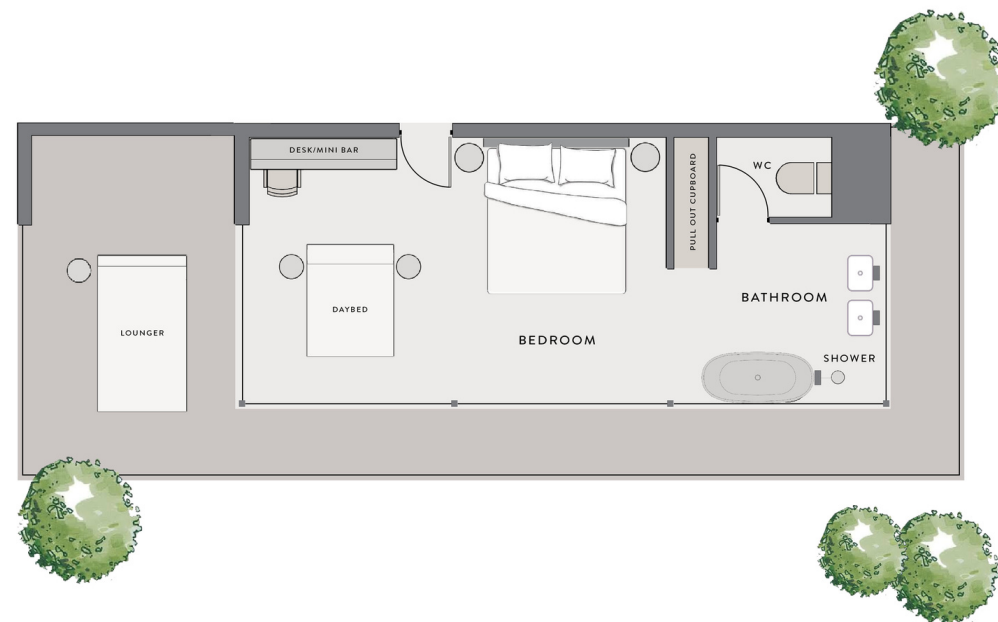



HONEYMOON SPACE

1 unit

Perched at the highest point of the ridge with dramatic wraparound views of the lush valley below, our breathtaking Honeymoon Space sets the scene for an impossibly romantic safari experience. This free-standing unit is open to the elements on three sides, with state-of-the-art retractable, remote-controlled screens in place of walls. It is furnished with a king-sized bed and features a comfortable daybed, an open-plan bathroom with indoor/outdoor shower and oversized bathtub, a well-stocked mini bar and a generous corner balcony for relaxing in the sun and taking in the view.

ROOM SIZE	64m ²
MAXIMUM NO. OF ADULT GUESTS	2
MAXIMUM NO. OF CHILDREN SHARING (AGED 10-12)*	1
OPTION FOR TWIN BEDS*	YES
MOSQUITO NETS	YES
AIR CONDITIONING	NO
CEILING FAN	YES
PRIVATE TERRACE	YES
OPEN-PLAN BATHROOM	YES
SEPARATE W.C.	YES
BATHTUB	YES
WALK-IN SHOWER	YES
MINI BAR	YES
HAIR DRYER	YES
TV	NO
DIGITAL SAFE	YES
WHEELCHAIR FRIENDLY	NO

**On request*

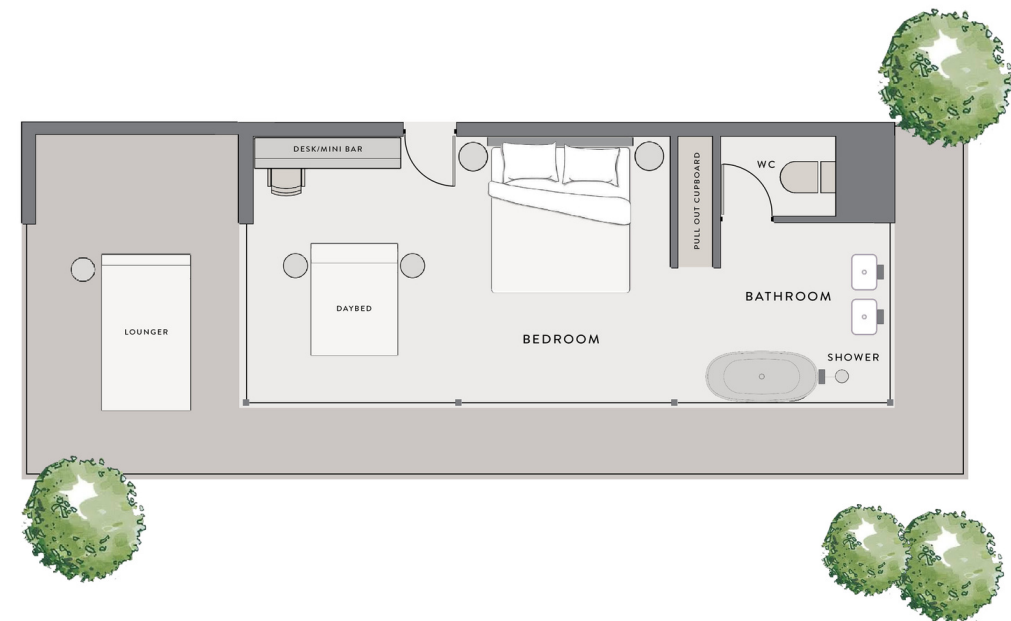



THE OUTPOST

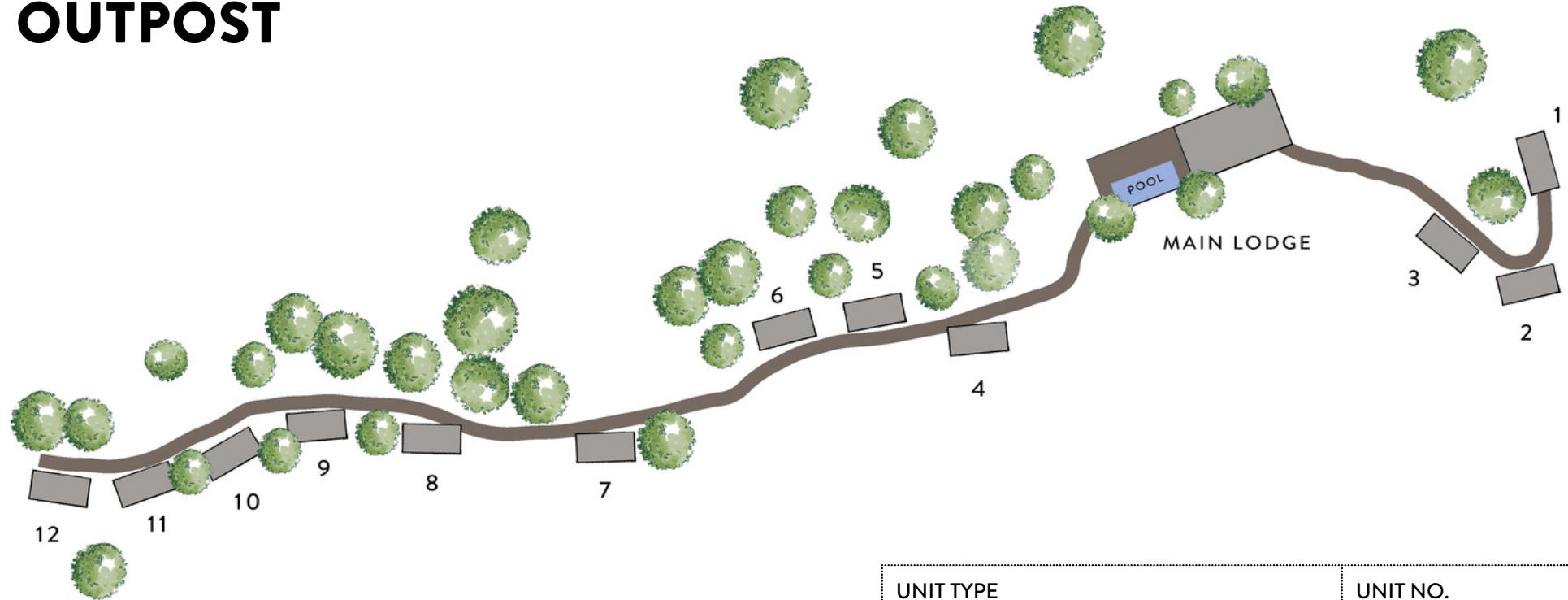

UNIT TYPE	UNIT NO.
BUSH VIEW SPACES	1, 2, 3 & 4
TREETOP SPACES	5 & 6
RIVER VIEW SPACES	7, 8, 9, 10 & 11
HONEYMOON SPACE	12



THE OUTPOST

CONTACT

For further information, please contact:
reservations@rareearth.co.za or +27 (0)11 568 0384
www.rareearth.co.za